

# PRESS BRAKE TOOLS

SPECIAL TOOLING

PRODUCT CATALOG

**AMADA TYPE**

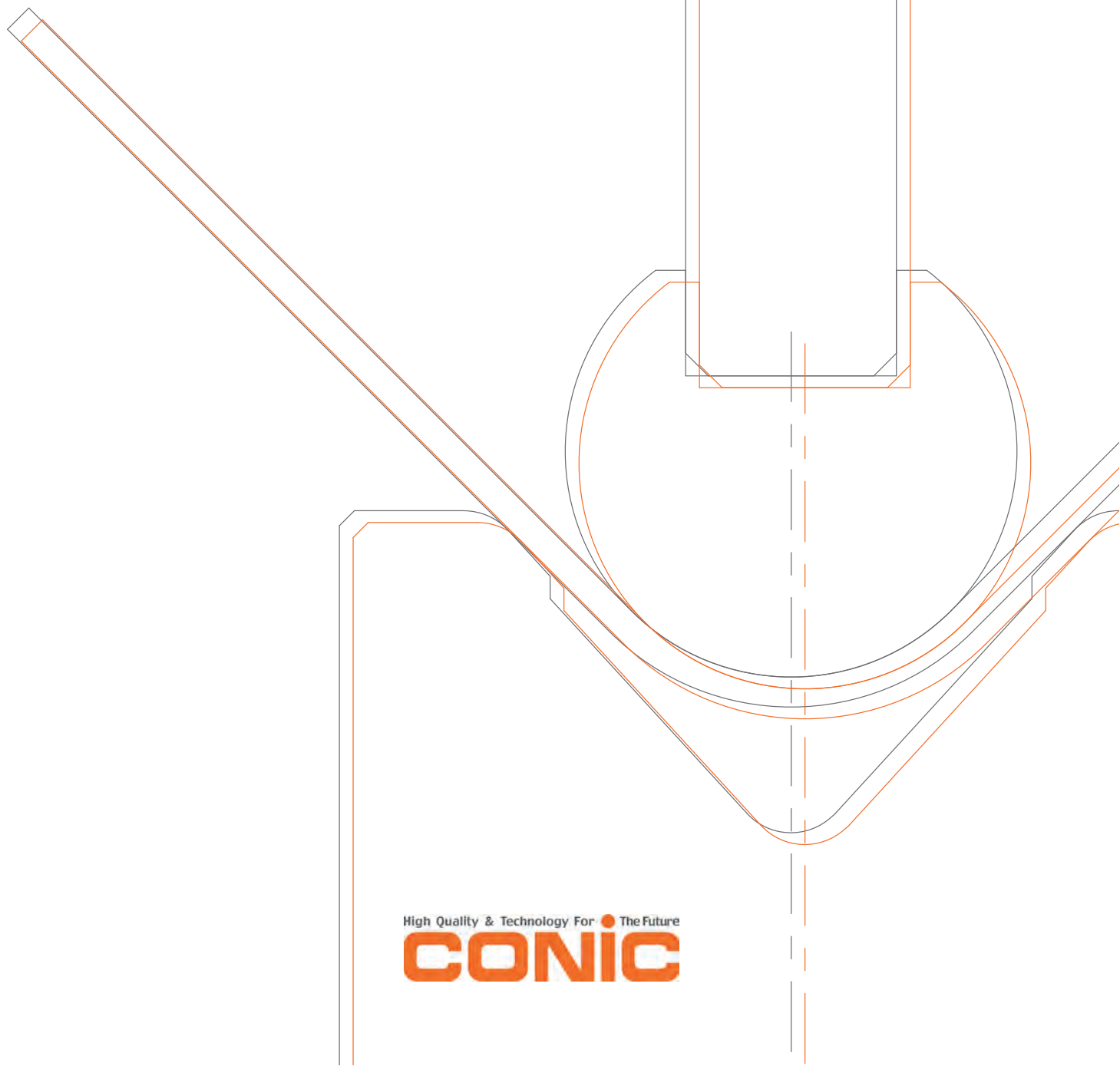

High Quality & Technology For The Future

**CONIC**

# INDEX

---

INFORMATION .....	03
CLAMP TYPE .....	04
R BENDING.....	05
DANSER.....	06
RIB BENDING TOOL.....	07
ONE STEP BENDING.....	08
SPECIAL SHAPE.....	09
LARGE TOOLS.....	10-11
SPECIAL COMBINATION DIE.....	12
OPTION.....	12
HEMMING.....	13
BEND CHART .....	14
ORDER FORM.....	15

\*Mentioned tonnage in the table is for standard type.

# INFORMATION

---

## ■ TOOL LENGTH

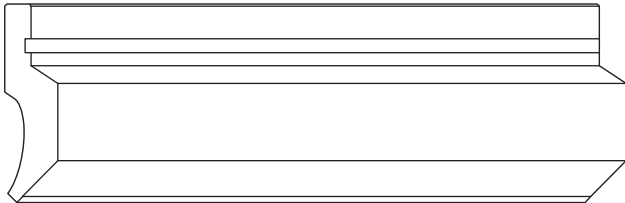

Type L 835 mm

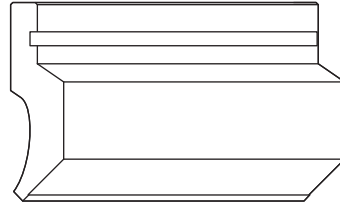

Type M 510 mm

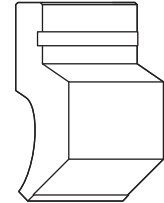

Type SS 200 mm

## ■ SECTIONING

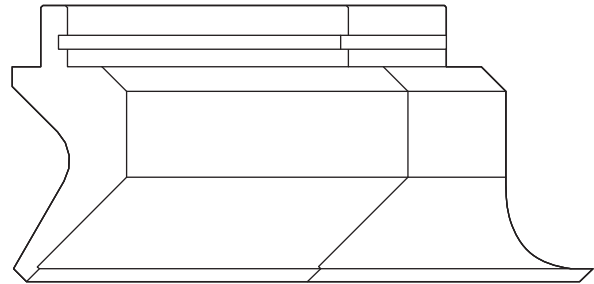
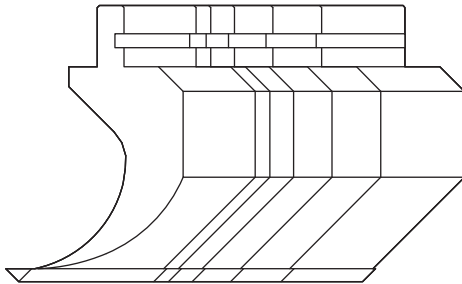

## ■ SECTIONING (PUNCH)

SECTIONING A (Total 370mm) 10 ▪ 10 ▪ 15 ▪ 20 ▪ 25 ▪ 40 ▪ 50 ▪ 100 ▪ 100

SECTIONING B (Total 800mm) 10 ▪ 15 ▪ 20 ▪ 40 ▪ 50 ▪ 100 ▪ 100 ▪ 165 ▪ 300

EARS 200mm 100 (Right) ▪ 100 (Left)

## ■ SECTIONING (DIE)

SECTIONING A (Total 370mm) 10 ▪ 10 ▪ 15 ▪ 20 ▪ 25 ▪ 40 ▪ 50 ▪ 100 ▪ 100

SECTIONING B (Total 800mm) 10 ▪ 15 ▪ 20 ▪ 40 ▪ 50 ▪ 100 ▪ 100 ▪ 165 ▪ 300

# CLAMP TYPE

---

## ■ OT-TYPE (One Touch)

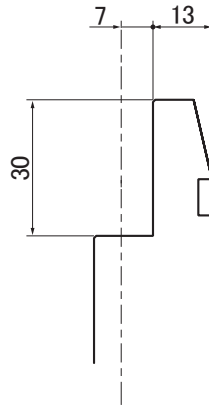

## ■ A9-TYPE (Safety Groove)

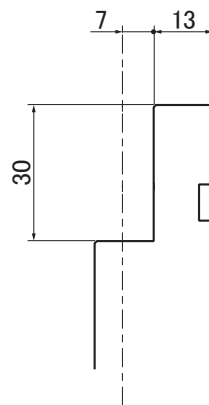

## ■ STANDARD-TYPE

Recommend other type

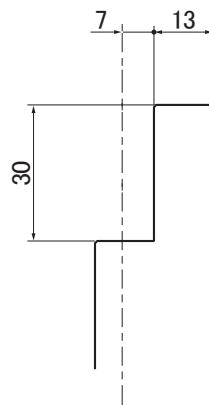

# SPECIAL TOOLS

---

## ■ R BENDING

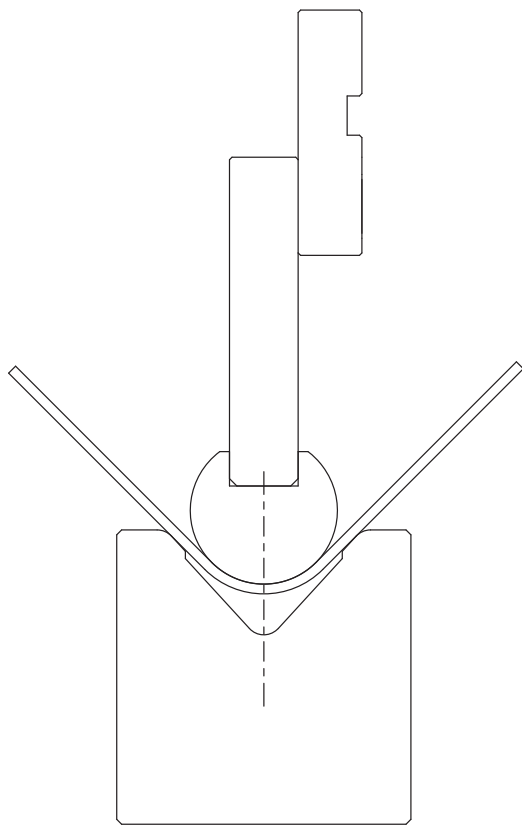

R BENDING (PUNCH TIP)

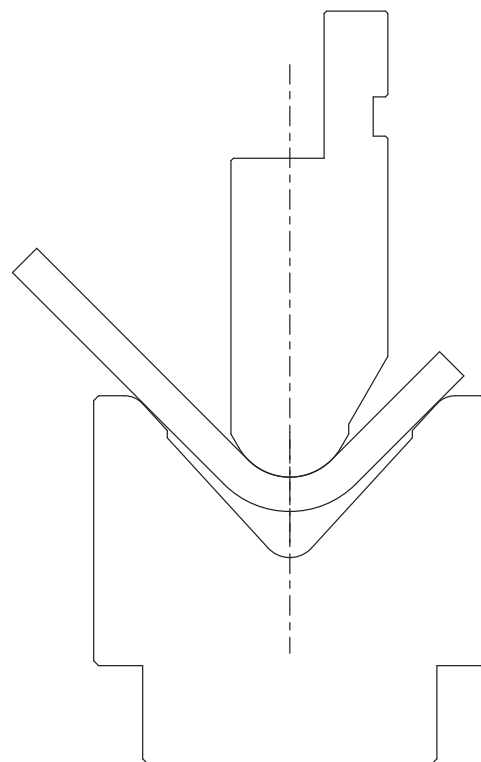

R BENDING (ONE PIECE PUNCH)

# SPECIAL TOOLS

## ■ DANSAR

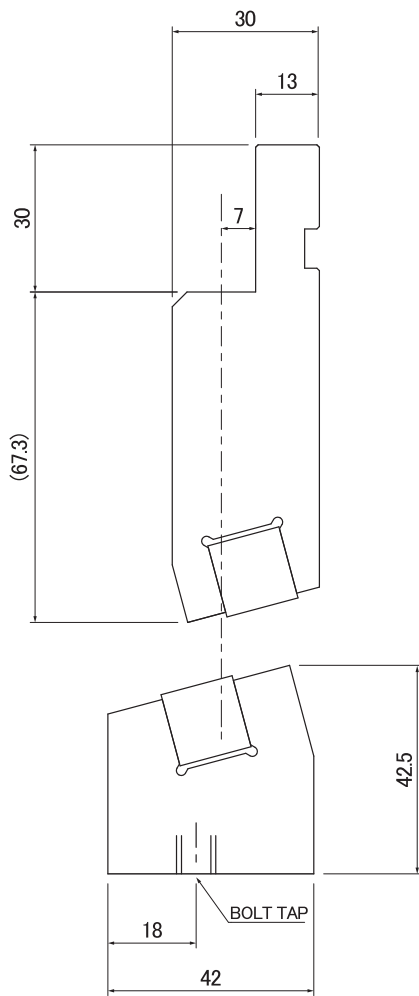

DANSAR DIE (HOLDER TYPE)

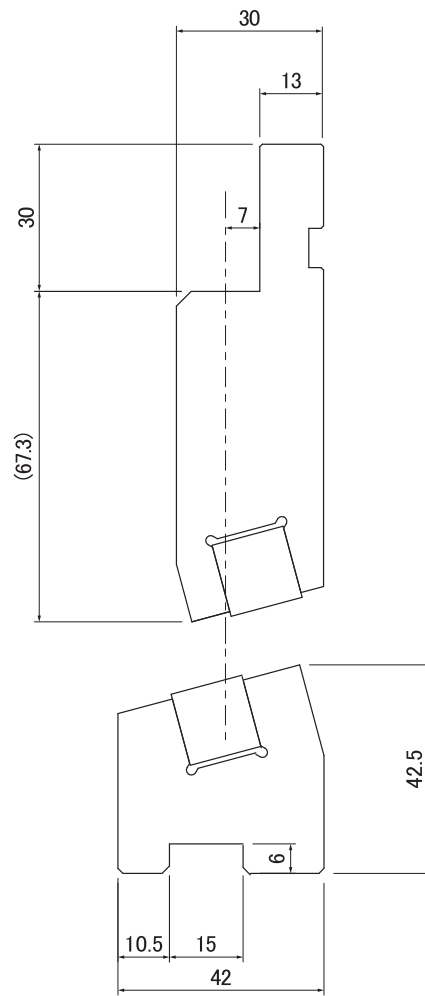

DANSAR DIE (RAIL TYPE)

# SPECIAL TOOLS

---

## ■ RIB BENDING TOOL

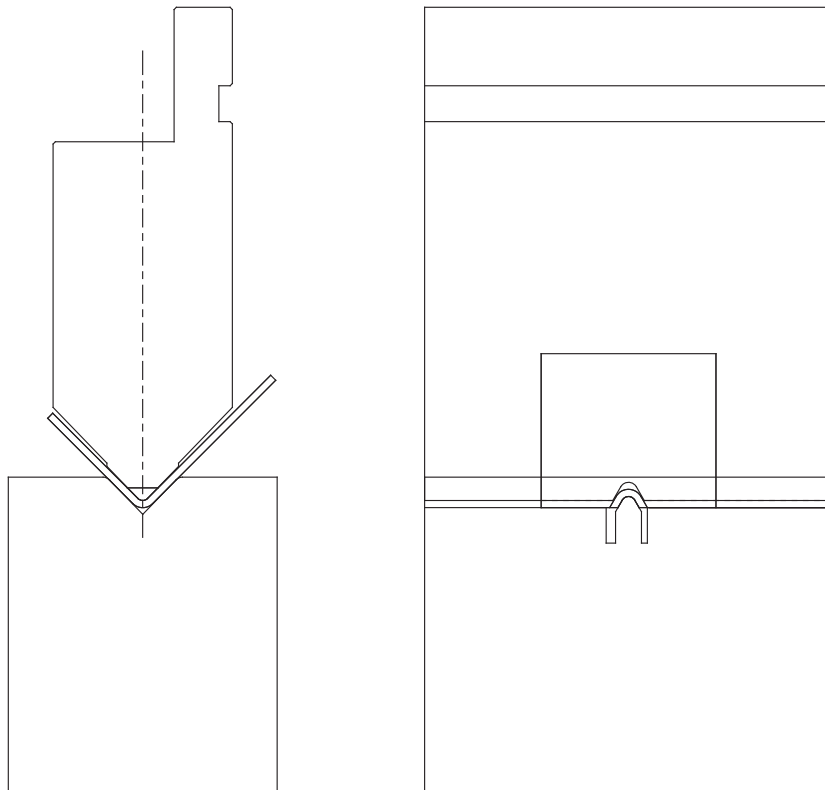

# SPECIAL TOOLS

---

## ■ ONE STEP BENDING

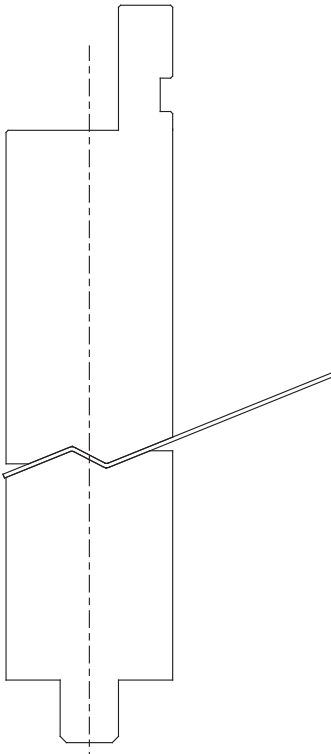

ORDER MADE  
OFFSET TOOL

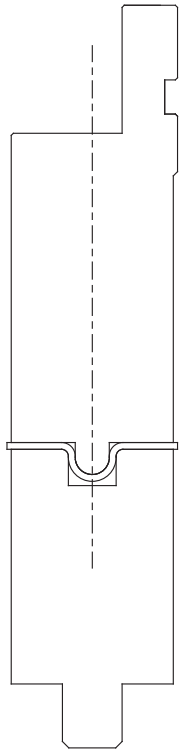

1 STEP SMALL  
BENDING TOOL

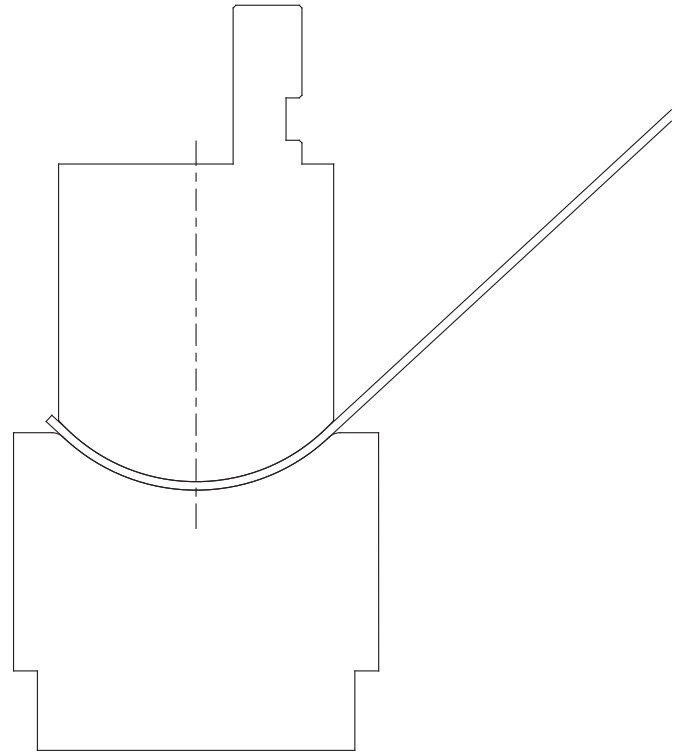

RADIUS FORMING TOOL

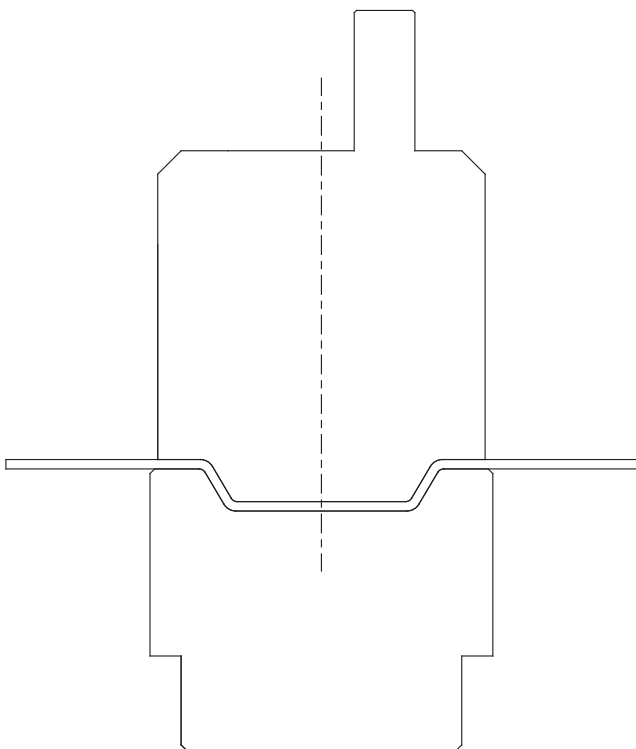

OPEN HAT  
BENDING TOOL

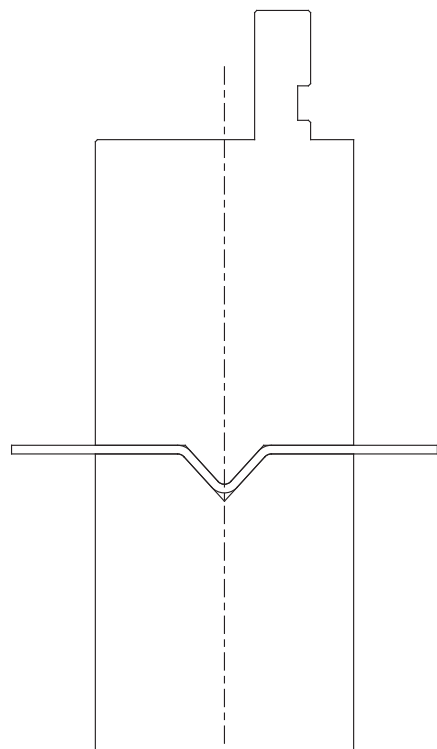

BEADING TOOL



# SPECIAL TOOLS

---

## ■ SPECIAL SHAPE

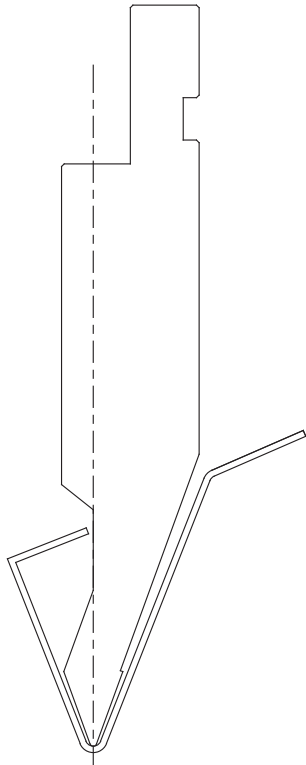

TRIANGLE BENDING PUNCH

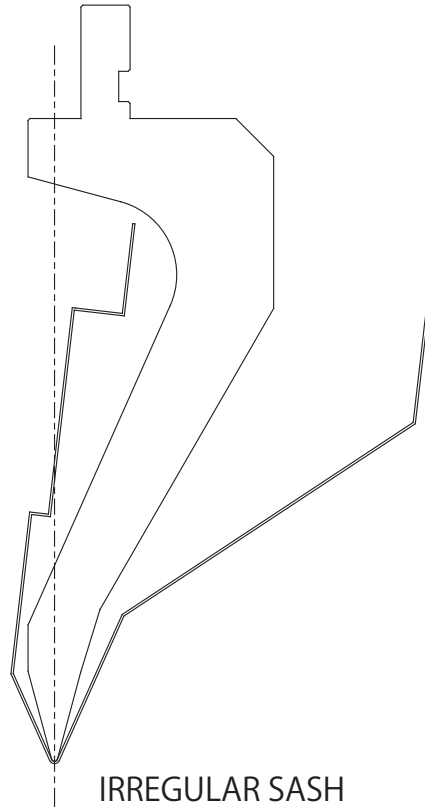

IRREGULAR SASH BENDING PUNCH

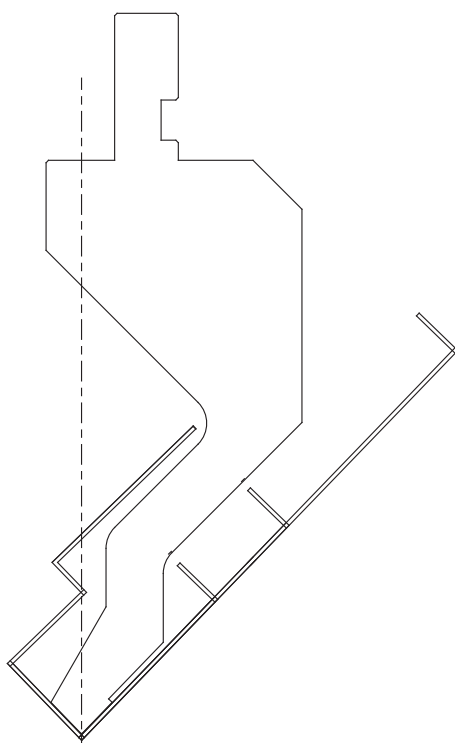

DEEP SASH BENDING PUNCH

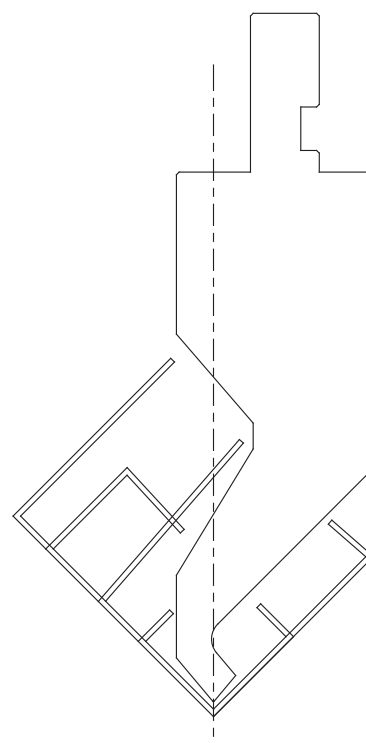

MULTI MATERIAL SASH BENDING PUNCH

# SPECIAL TOOLS

---

■ LARGE PUNCH

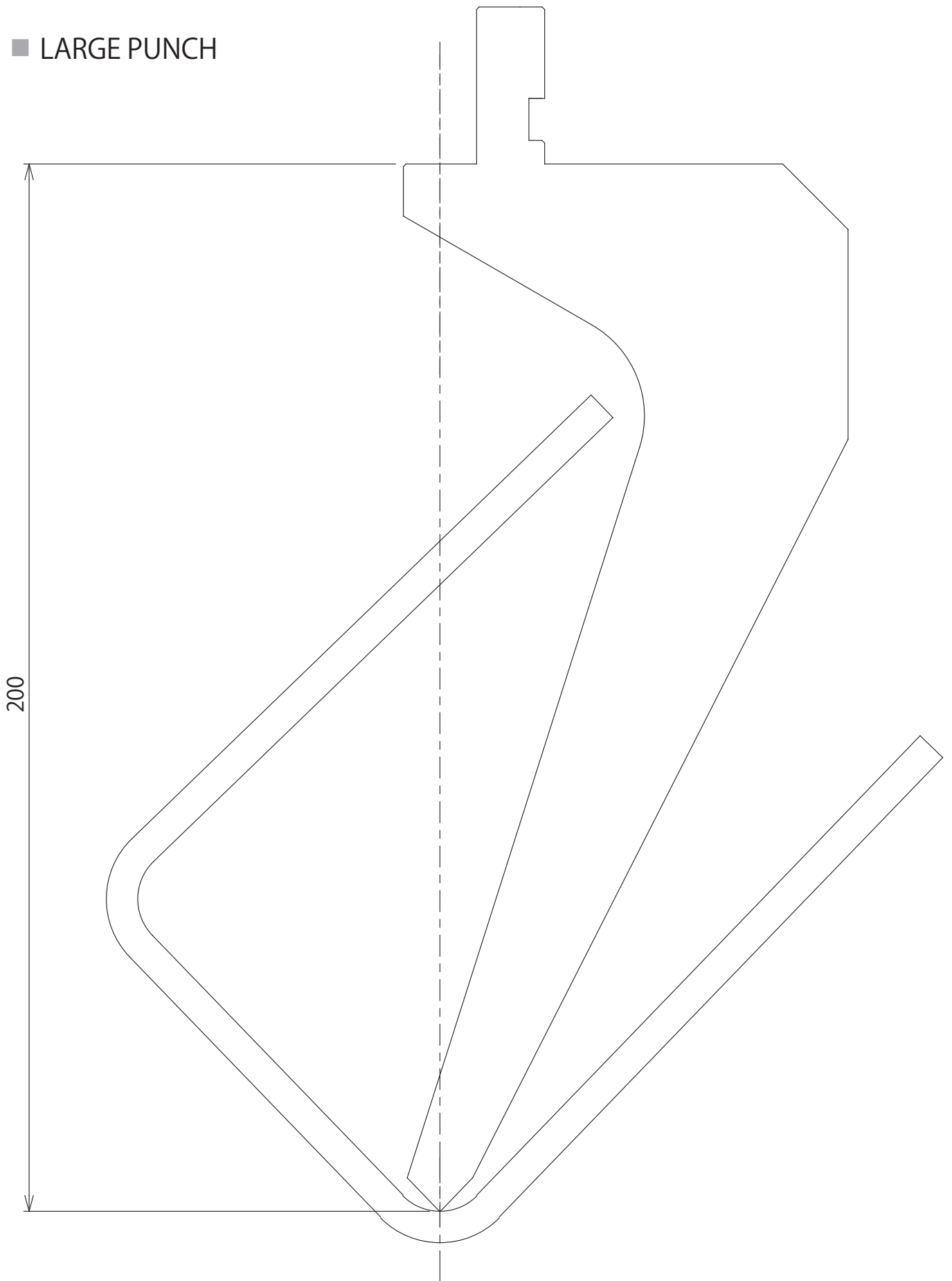

# SPECIAL TOOLS

## ■ LARGE DIE

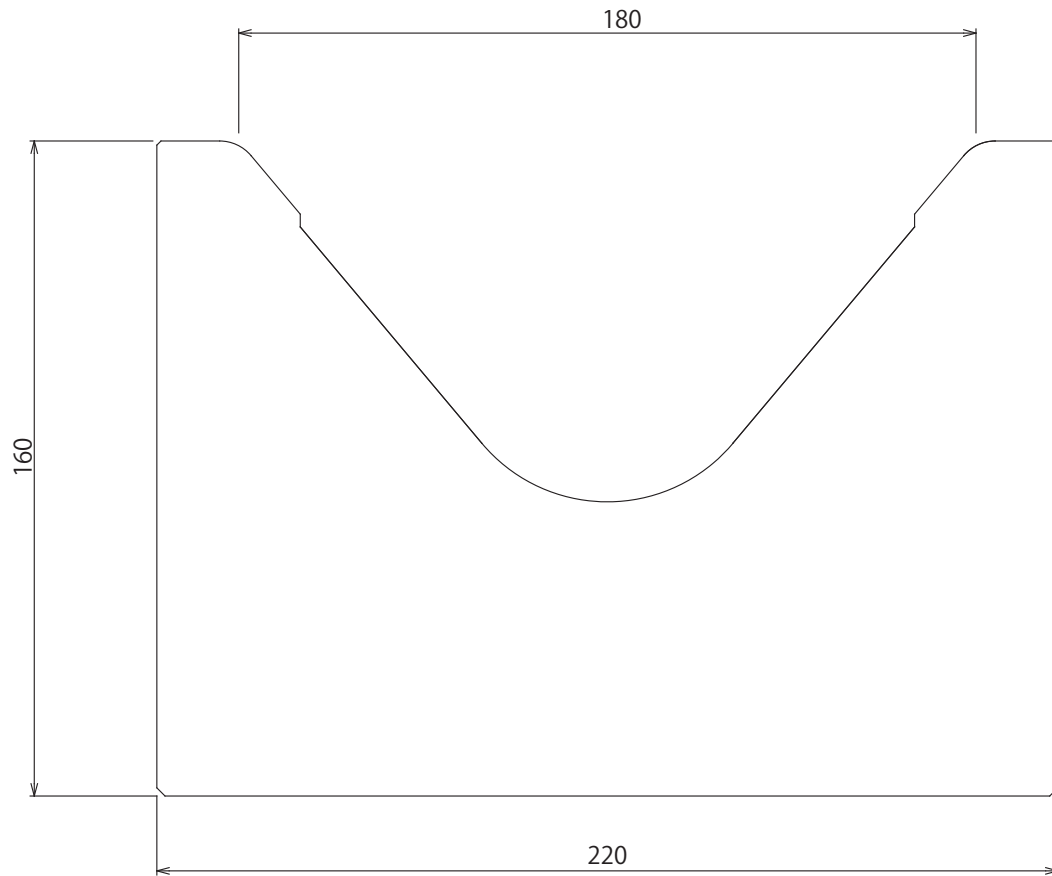

## ■ TALL DIE HOLDER

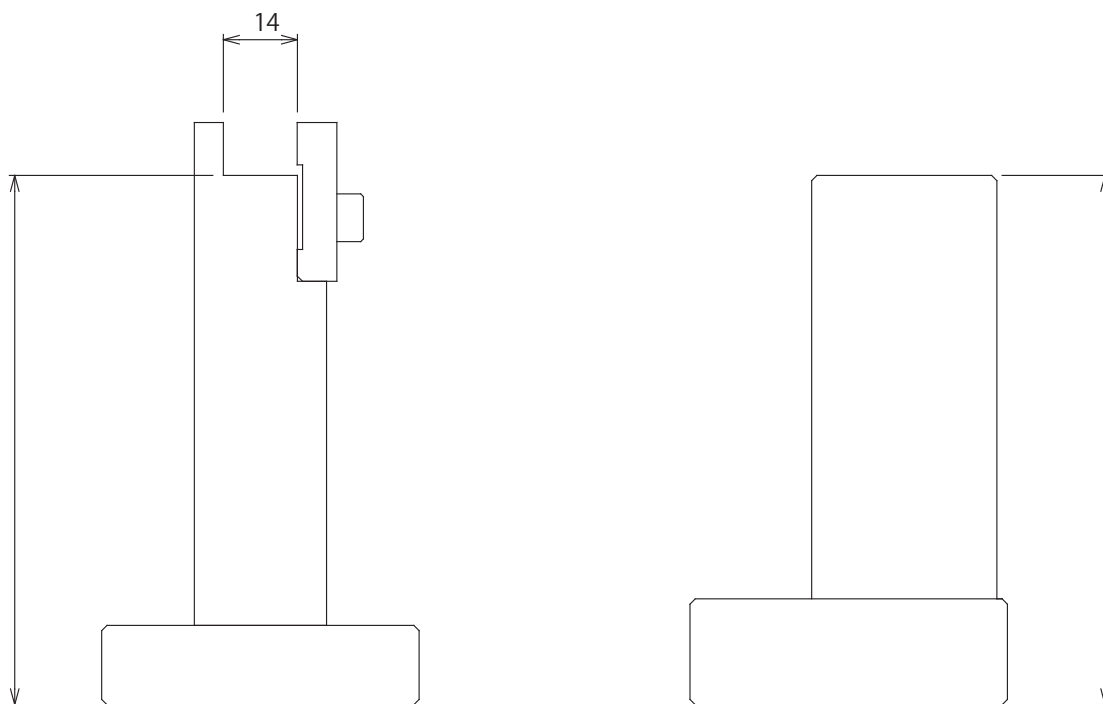

TALL 1V DIE HOLDER

TALL 2V DIE HOLDER

# SPECIAL TOOLS

## ■ SPECIAL COMBINATION DIE

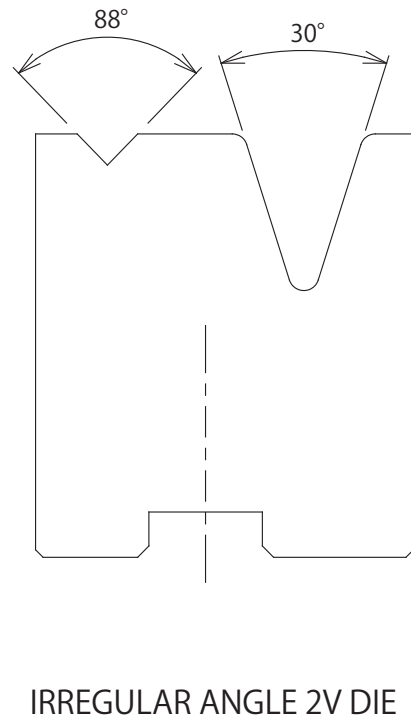
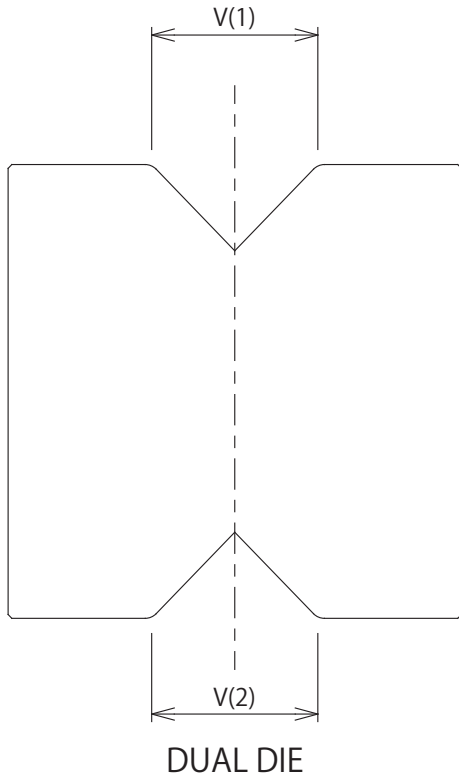

## ■ OPTION

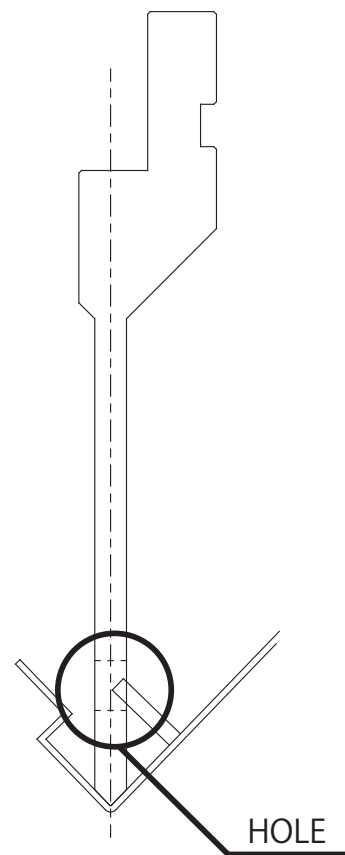
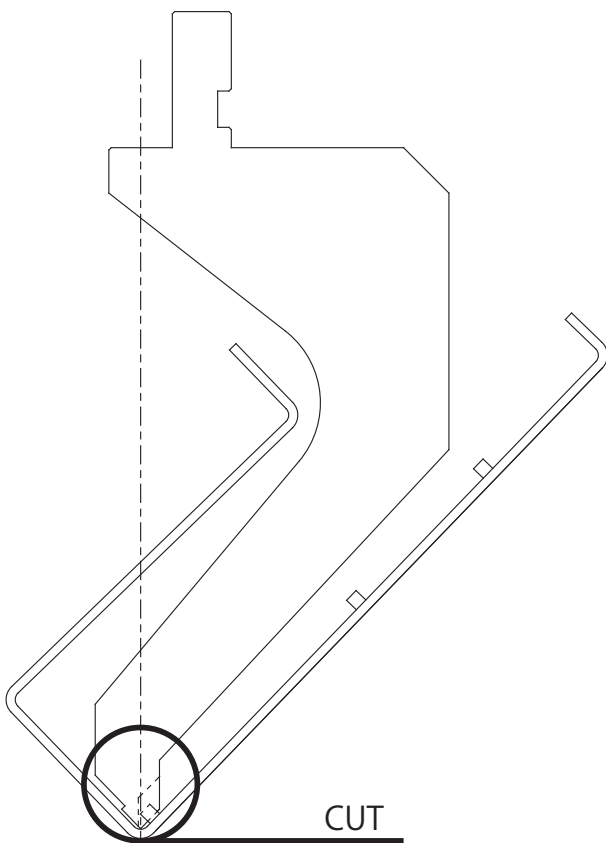

# SPECIAL TOOLS

## ■ FEATHER-HEMMING DIE

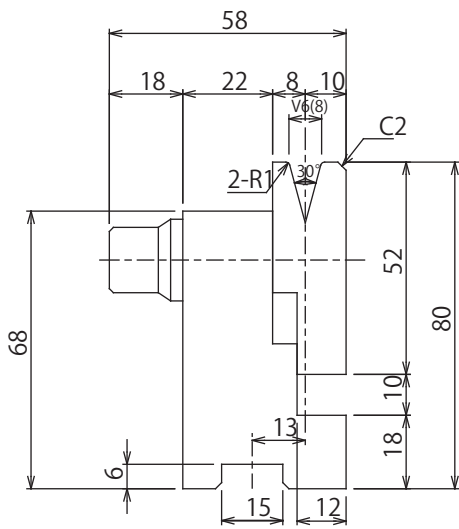

RAIL TYPE

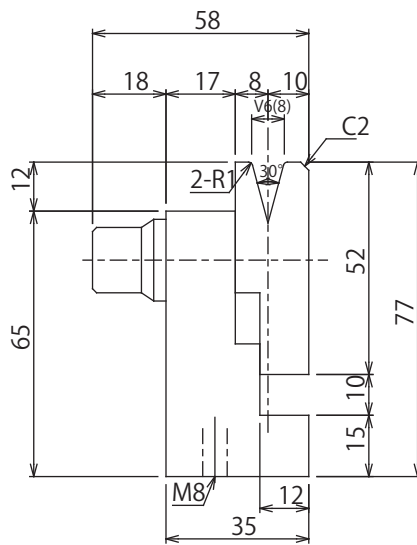

BOLT TYPE

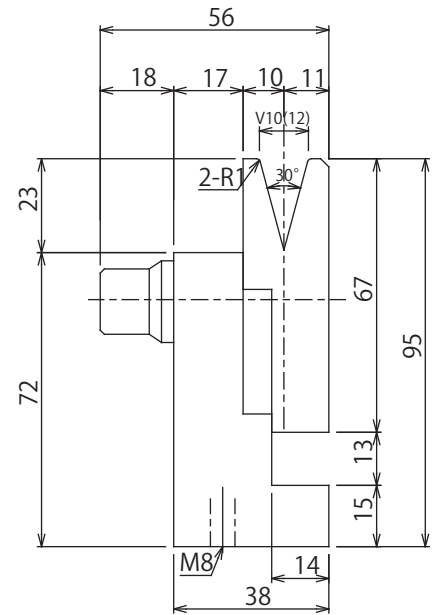

T-BOLT TYPE

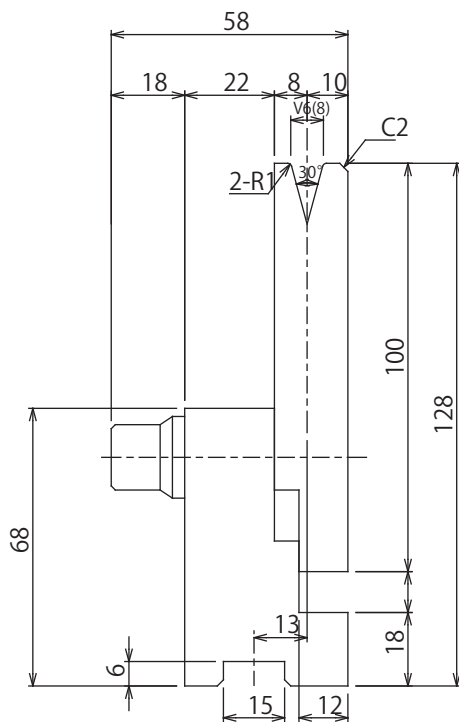

High-RAIL TYPE

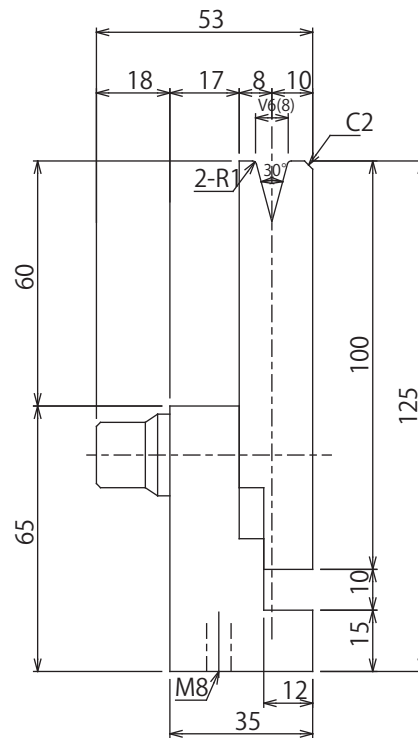

High-BOLT TYPE

Use acute angle(30°) bending then and flattening in continues in operation process.

# BEND CHART

t : Material thickness

F : Pressure per 1m (kN/m)

b : Minimum length of flange

(Tensile Strength 450~500N/mm<sup>2</sup>)

ir : Radius of punch tip

v : Width of die

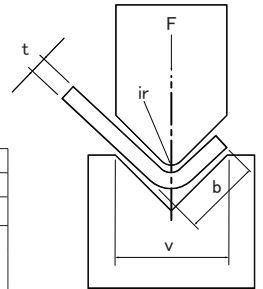

## For mild steel

t	4	6	7	8	10	12	14	16	18	20	25	32	40	50	63	80	100	125	160	200	250	v	
(mm)	0.7	1	1.1	1.3	1.6	2	2.3	2.6	3	3.3	4	5	6.5	8	10	13	16	20	26	33	41	b	
																						ir	
0.5	40	30																					
0.6	60	40	40	40																			
0.8		70	70	50	40																		
1		110	100	80	70	60																	
1.2			140	120	110	80	70	60															
1.4				150	130	110	100	90	80														
1.5				200	170	150	130	110	100	90													
1.6					170	150	130	110	100	90													
2						220	190	170	150	130	110												
2.3							250	230	190	170	150	120											
2.6								280	250	220	180	140											
3									340	300	240	190	150										
3.2										340	270	220	170	140									
3.5											330	260	200	160	130								
4											430	340	270	210	170								
4.5												440	340	270	210								
5												520	420	330	260	210							
6													600	480	380	300	240						
7															520	410	330	260					
9																670	540	430					
10																850	670	530	420				
12																	960	780	600	550			
16																		1360	1070	860			
19																			1500	1250	1000		
20																			1700	1350	1080		
22																					1600	1300	
25																					2100	1700	
30																						2400	

F (kN)

## For stainless steel

t	4	6	7	8	10	12	14	16	18	20	25	32	40	50	63	80	100	125	160	200	250	v	
(mm)	0.7	1	1.1	1.3	1.6	2	2.3	2.6	3	3.3	4	5	6.5	8	10	13	16	20	26	33	41	b	
																							ir
0.5	60	50																					
0.6	90	60	60	60																			
0.7	120	80	80	60	60																		
0.8		110	110	80	70																		
0.9		130	120	100	90	70																	
1		170	150	120	110	90																	
1.2			210	180	150	120	110	90															
1.5				290	230	200	170	150	130	120													
2						330	290	260	230	200	170												
2.5									390	350	300	250	190										
3										510	450	360	290	230									
4											650	510	410	320	260								
5												780	630	500	390	320							
6													900	720	570	450	360						
8															1020	810	650	510					
10																1290	1010	800	630				
12																	1440	1170	900	830			
15																		1800	1410	1140			
20																			2500	2080	1670		
25																					3150	2550	
30																						3600	

F (kN)



## PRODUCT CATALOG

### AMADA TYPE

#### CONIC HIGH PERFORMANCE TOOLING

- AMADA TYPE TOOLING
- TRUMPF TYPE TOOLING
- MURATA TYPE TOOLING
- KOMATSU TYPE TOOLING
- TOYO TYPE TOOLING
- NISSHINBO TYPE TOOLING

Download for your mobile.



High Quality & Technology For  The Future

# CONIC

#### CONIC CO., LTD

10-5 Taihei-dai, Shoo-cho, Katsuta-gun, Okayama 709-4321 Japan

Tel: (+81) 868 38 6154 | Fax: (+81) 868 38 6331

Email: [tools@conic.co.jp](mailto:tools@conic.co.jp) | Website: [www.conic.co.jp](http://www.conic.co.jp)

#### CONIC PRECISION CO., LTD

55/22 moo 4. Buengkumphroy, Lumlukka, Phatumthani 12150 Thailand

Tel: (+66) 2 159 9870-1 | Fax: (+66) 2 159 9872

Email: [conic\\_thai@conic.co.jp](mailto:conic_thai@conic.co.jp) | Website: [www.conic.co.jp/thai/](http://www.conic.co.jp/thai/)

#### THE REPRESENTATIVE OFFICE OF CONIC CO., LTD. IN HO CHI MINH CITY

4F VIN Office building | No. 362/19 Ung Van Khiem St., Ward 25, Binh Thanh Dist., H.C.M.C, Vietnam

Tel: (+84) 28 7300 0250

Email: [conic\\_vn@conic.co.jp](mailto:conic_vn@conic.co.jp)

Dealer