

PRESS BRAKE TOOLS

STANDARD TOOLING LIST

PRODUCT CATALOG

TRUMPF TYPE

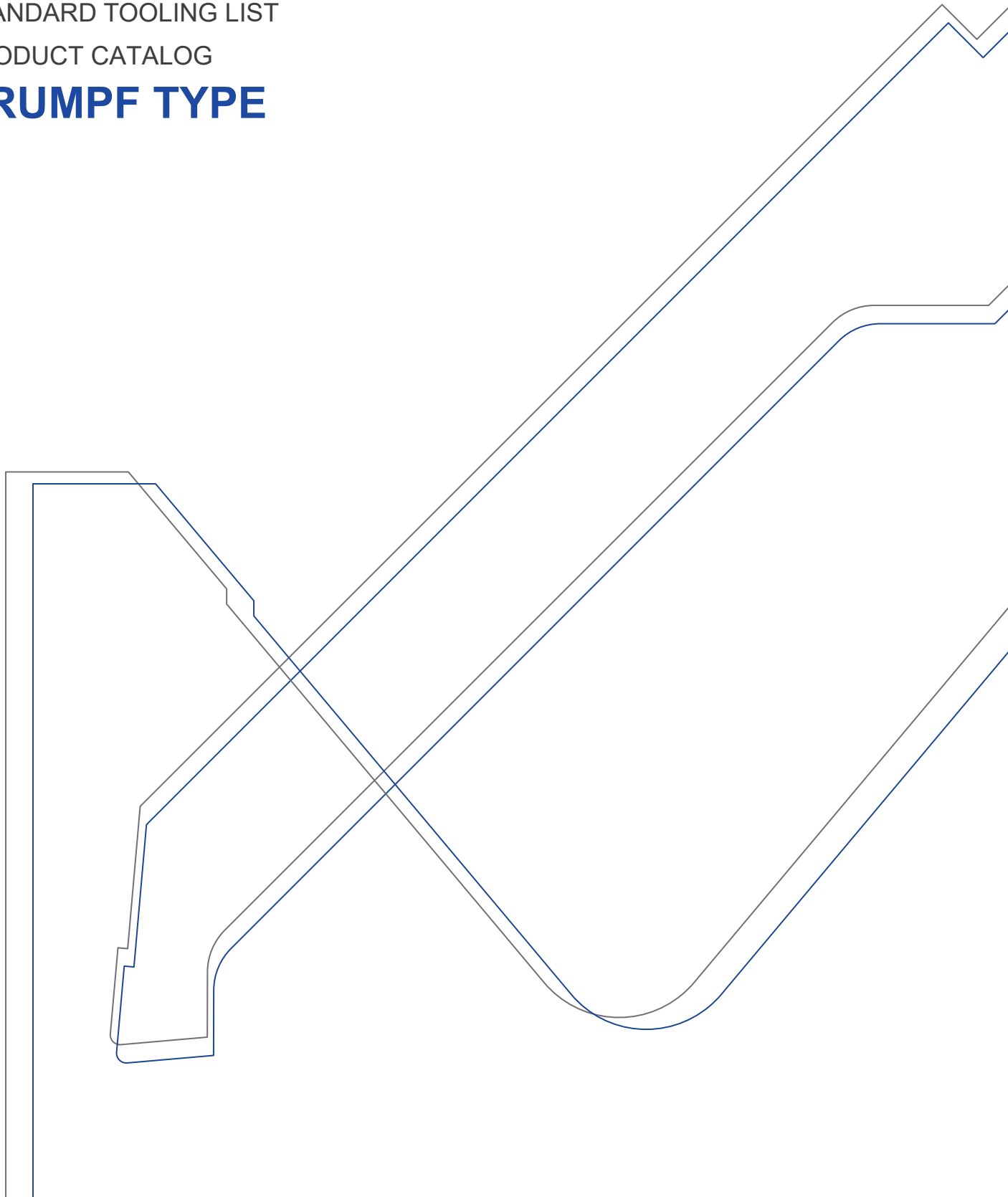

High Quality & Technology For  The Future

CONIC

INFORMATION

■ TOOL LENGTH(PUNCH & DIE)

STANDARD LENGTH 500 mm

* 415 mm and 835 mm are also available upon request

■ SECTIONING (PUNCH)

SECTIONING TR (Total 550 mm) 25·25·30·35·40·45·50·100·100 (Right)·100(Left)







* 835 mm is also available upon request

■ SECTIONING (DIE)

SECTIONING TR (Total 550 mm) 25·25·30·35·40·45·50·100·100·100

*835 mm is also available upon request

■ SECTIONING LENGTH SAMPLE

				550									
	<table border="1" data-bbox="646 1198 758 1310"><tr><td>1</td></tr><tr><td>x</td></tr><tr><td>200</td></tr></table>	1	x	200	<table border="1" data-bbox="805 1198 973 1310"><tr><td>1</td></tr><tr><td>x</td></tr><tr><td>300</td></tr></table>	1	x	300		1050			
1													
x													
200													
1													
x													
300													
	<table border="1" data-bbox="646 1355 758 1467"><tr><td>2</td></tr><tr><td>x</td></tr><tr><td>200</td></tr></table>	2	x	200	<table border="1" data-bbox="805 1355 973 1467"><tr><td>1</td></tr><tr><td>x</td></tr><tr><td>300</td></tr></table>	1	x	300		1250			
2													
x													
200													
1													
x													
300													
	<table border="1" data-bbox="646 1512 758 1624"><tr><td>1</td></tr><tr><td>x</td></tr><tr><td>200</td></tr></table>	1	x	200	<table border="1" data-bbox="805 1512 973 1624"><tr><td>1</td></tr><tr><td>x</td></tr><tr><td>300</td></tr></table>	1	x	300	<table border="1" data-bbox="1029 1512 1300 1624"><tr><td>2</td></tr><tr><td>x</td></tr><tr><td>500</td></tr></table>	2	x	500	2050
1													
x													
200													
1													
x													
300													
2													
x													
500													
	<table border="1" data-bbox="646 1668 758 1780"><tr><td>1</td></tr><tr><td>x</td></tr><tr><td>200</td></tr></table>	1	x	200	<table border="1" data-bbox="805 1668 973 1780"><tr><td>1</td></tr><tr><td>x</td></tr><tr><td>300</td></tr></table>	1	x	300	<table border="1" data-bbox="1029 1668 1300 1780"><tr><td>3</td></tr><tr><td>x</td></tr><tr><td>500</td></tr></table>	3	x	500	2550
1													
x													
200													
1													
x													
300													
3													
x													
500													
	<table border="1" data-bbox="646 1825 758 1937"><tr><td>1</td></tr><tr><td>x</td></tr><tr><td>200</td></tr></table>	1	x	200	<table border="1" data-bbox="805 1825 973 1937"><tr><td>1</td></tr><tr><td>x</td></tr><tr><td>300</td></tr></table>	1	x	300	<table border="1" data-bbox="1029 1825 1300 1937"><tr><td>4</td></tr><tr><td>x</td></tr><tr><td>500</td></tr></table>	4	x	500	3050
1													
x													
200													
1													
x													
300													
4													
x													
500													
	<table border="1" data-bbox="646 1982 758 2094"><tr><td>1</td></tr><tr><td>x</td></tr><tr><td>200</td></tr></table>	1	x	200	<table border="1" data-bbox="805 1982 973 2094"><tr><td>1</td></tr><tr><td>x</td></tr><tr><td>300</td></tr></table>	1	x	300	<table border="1" data-bbox="1029 1982 1300 2094"><tr><td>6</td></tr><tr><td>x</td></tr><tr><td>500</td></tr></table>	6	x	500	4050
1													
x													
200													
1													
x													
300													
6													
x													
500													

CLAMP TYPE

■ **STANDARD TYPE**

Recommend other type

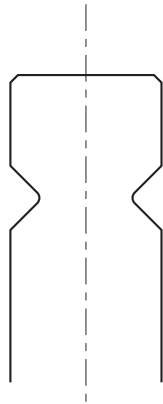

■ **SAFETY-PIN TYPE**

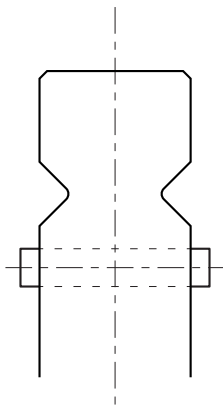

■ **SAFETY-KEY TYPE**

We do not supply this type

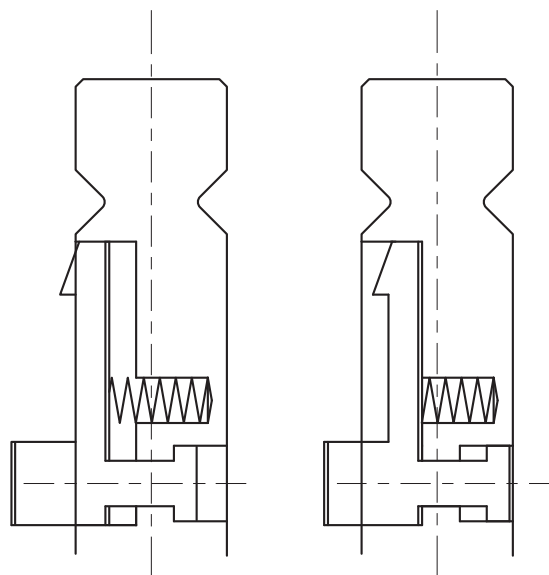

STANDARD PUNCH

Material: **SCM440** Hardness: **HRC47 ± 3**

Standard length : 500mm · 300mm · 200mm

Sectioning TR : 550 mm

Type	H (mm)	α Angle	R (mm)	K (mm)	Max (ton/m)	Product No.
	COP-003	135	86	1.0	8	
157		COP-003-157				
200		COP-003-200				
COP-015	157	90	0.6	-	60	COP-015-157
COP-016			1.2		100	COP-016-157

■ COP-003

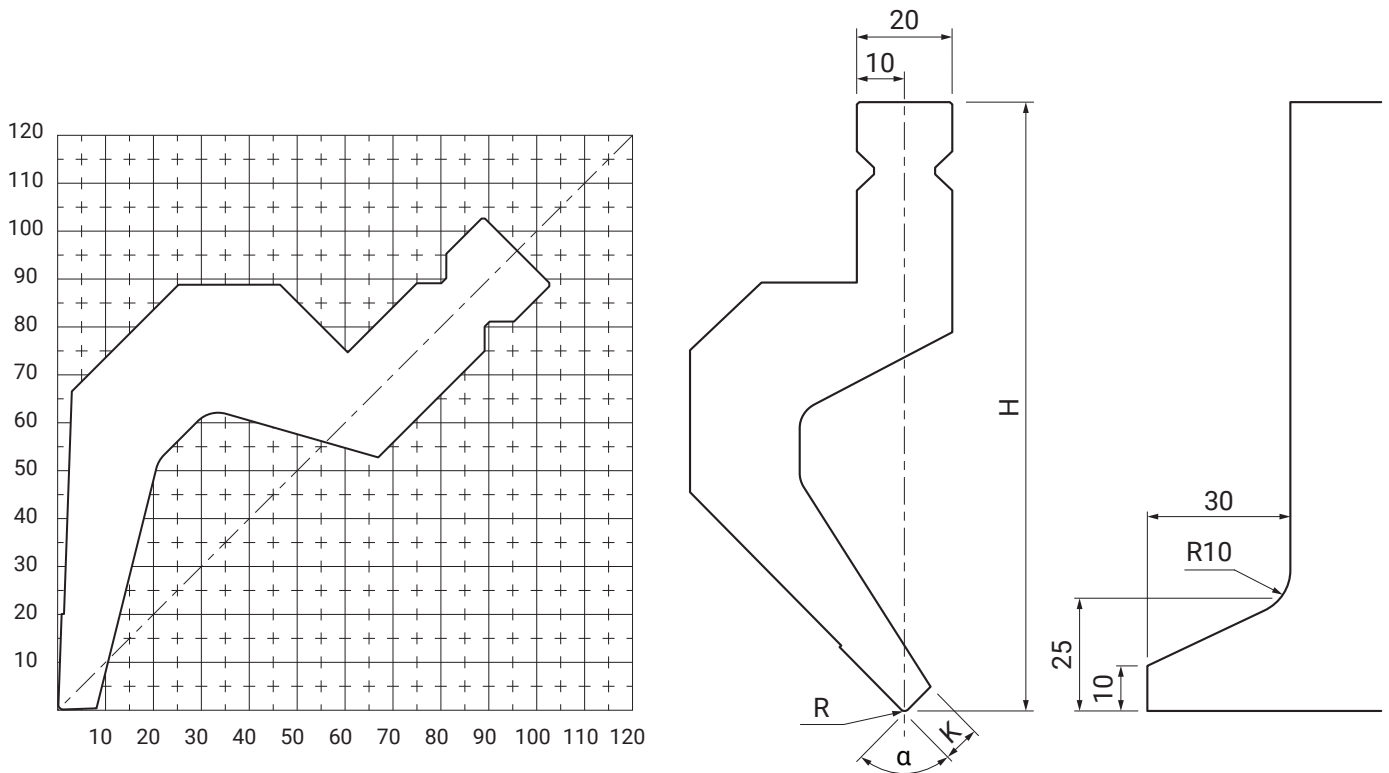

■ COP-015

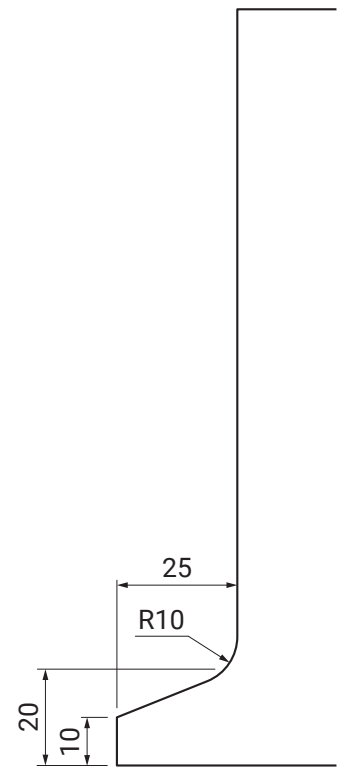
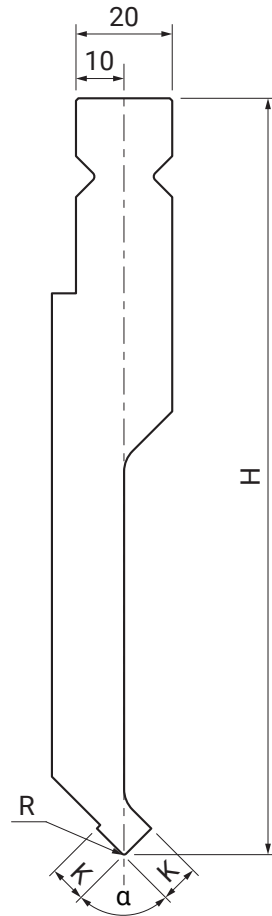
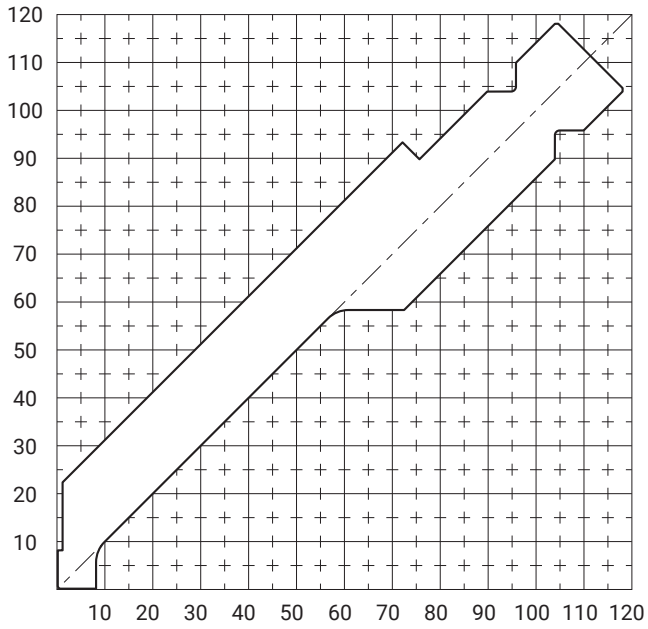

■ COP-016

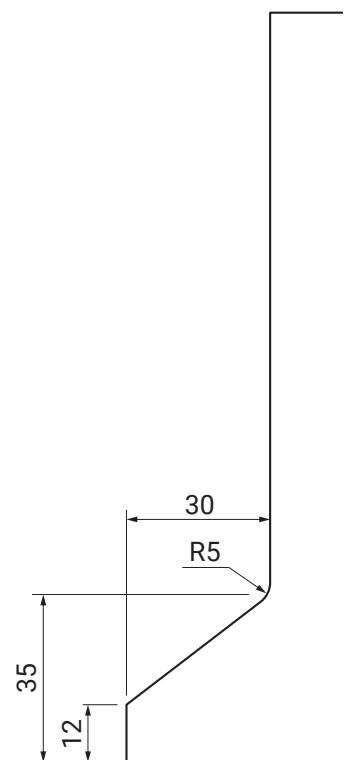
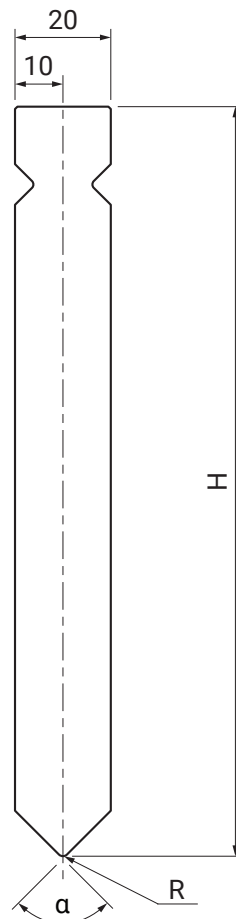
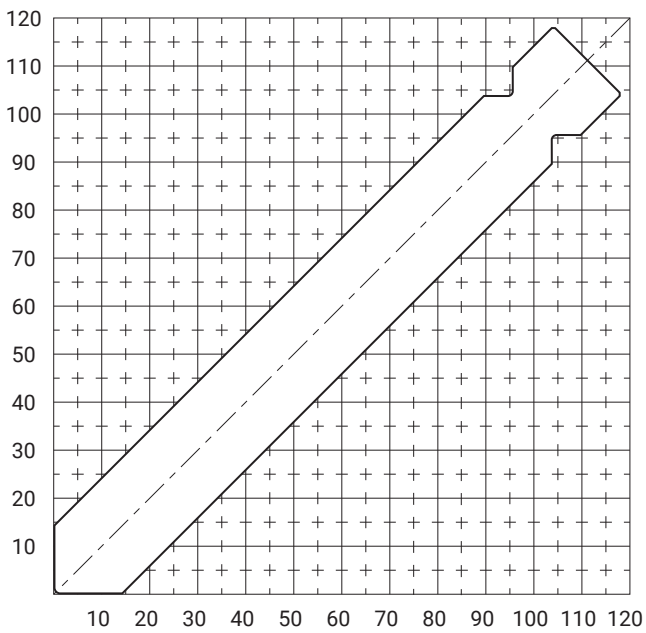

HEMMING PUNCH

Material: **SCM440** Hardness: **HRC47 ± 3**

Standard length : 500mm · 300mm · 200mm

Sectioning TR : 550 mm

Type	H	α	R	Max	Product No.
	(mm)	Angle	(mm)	(ton/m)	
COP-001	135	28	1.0	30	COP-001-135
	157				COP-001-157
COP-061	157			50	COP-061-157
COP-051				100	COP-051-157

■ COP-001

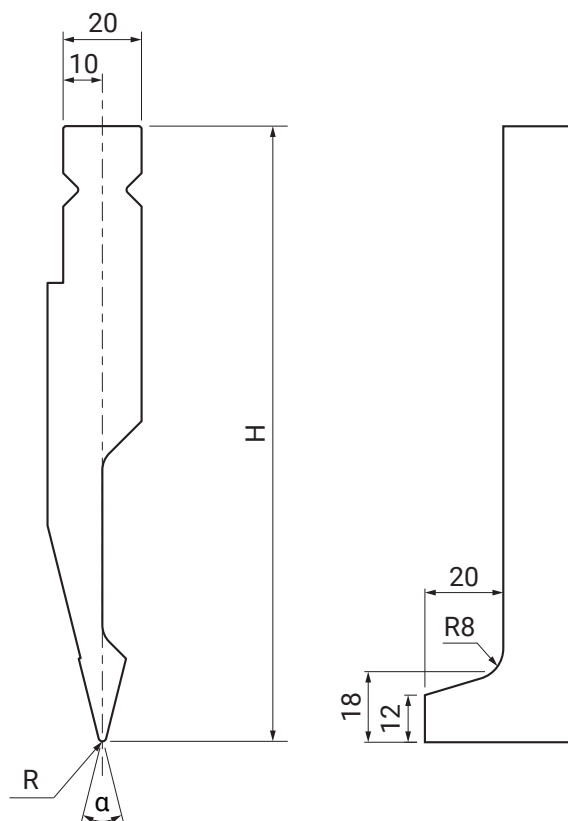
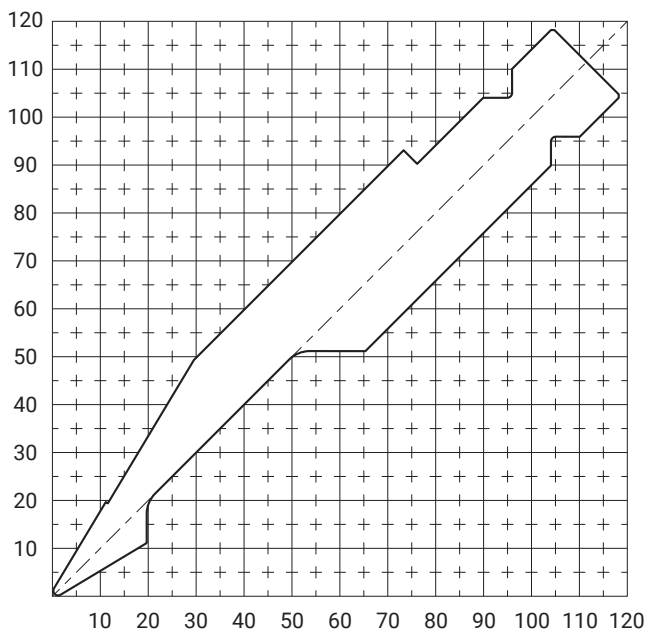

■ COP-061

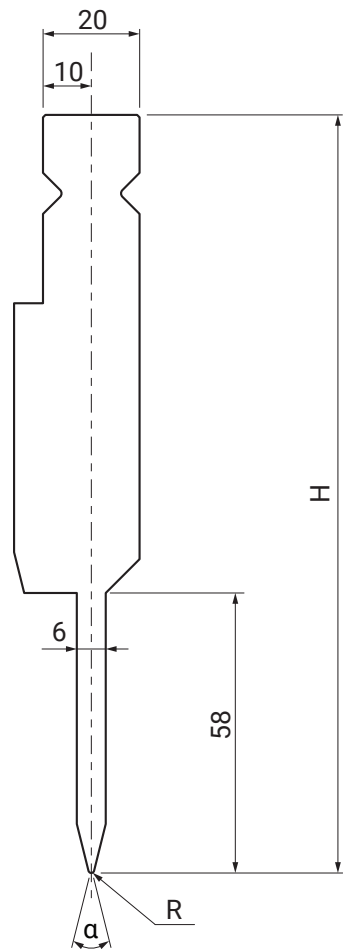
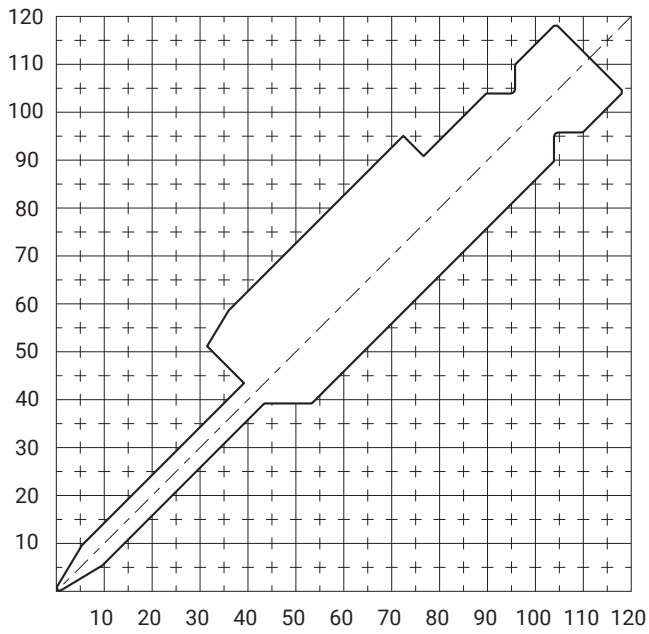

■ COP-051

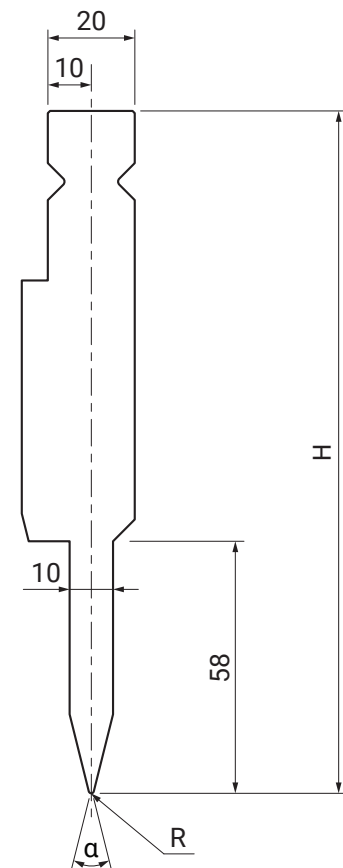
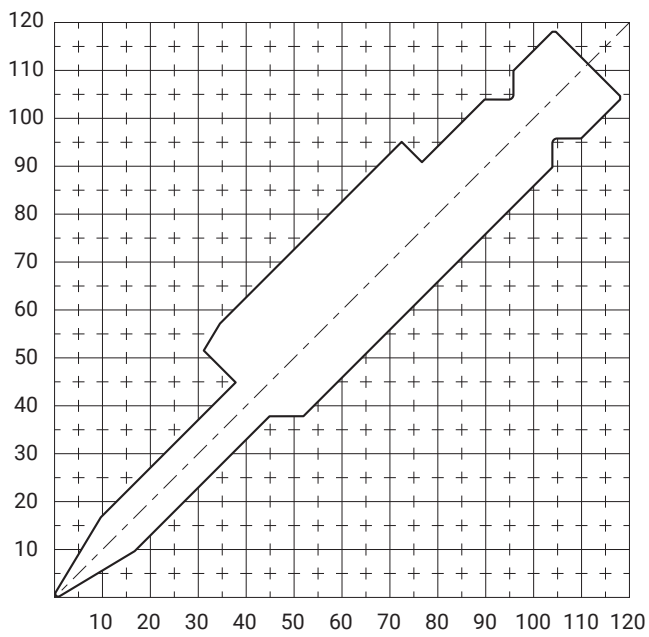

SPECIAL SHAPE PUNCH

Material: **SCM440** Hardness: **HRC47 ± 3**

Standard length : 500mm · 300mm · 200mm

Sectioning TR : 550 mm

Type	H	α	R	K	Max	Product No.
	(mm)	Angle	(mm)	(mm)	(ton/m)	
COP-004	135	60	3.0	-	100	COP-004-135
	175					COP-004-175
	200					COP-004-200
COP-002	135	80	1.0	10	60	COP-002-135
	175					COP-002-175
	200		COP-002-200			
COP-025	200		6.0	18.6		COP-025-200

■ COP-004

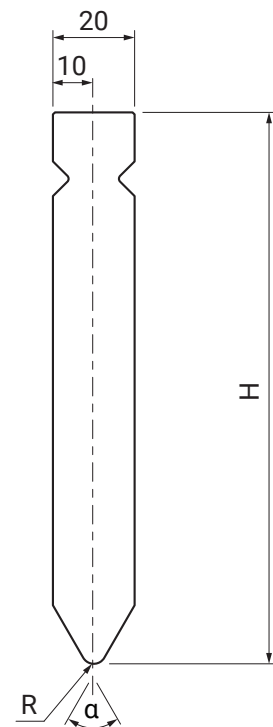
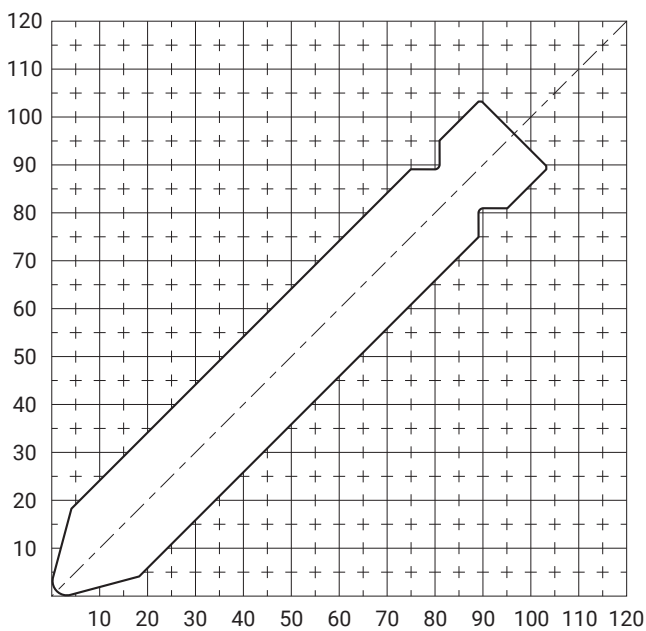

■ COP-002

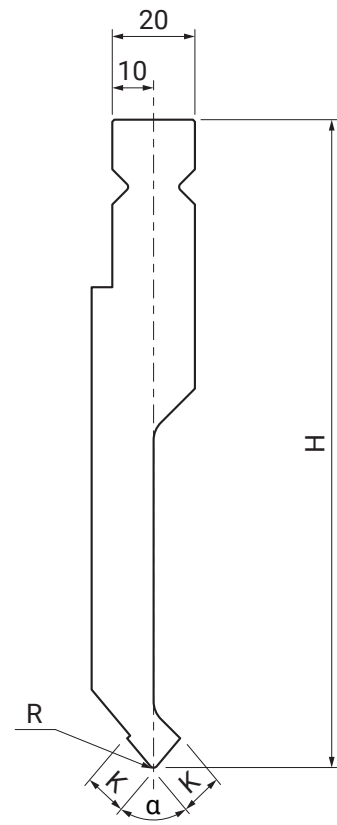
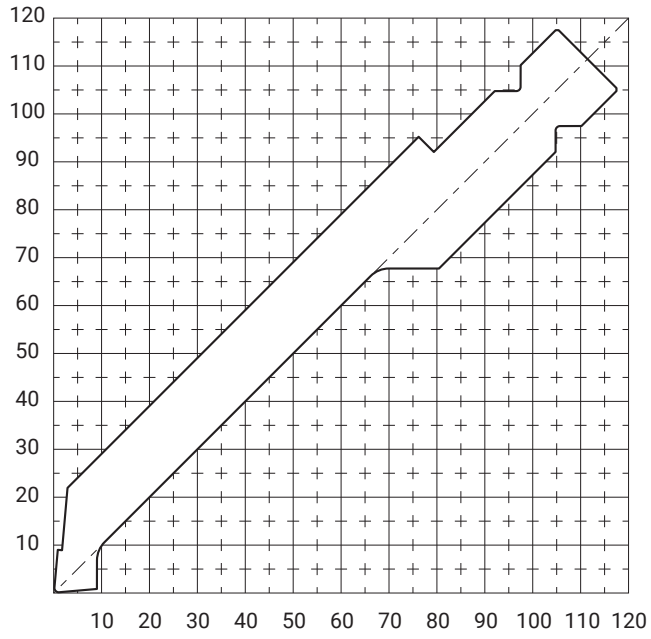

■ COP-025

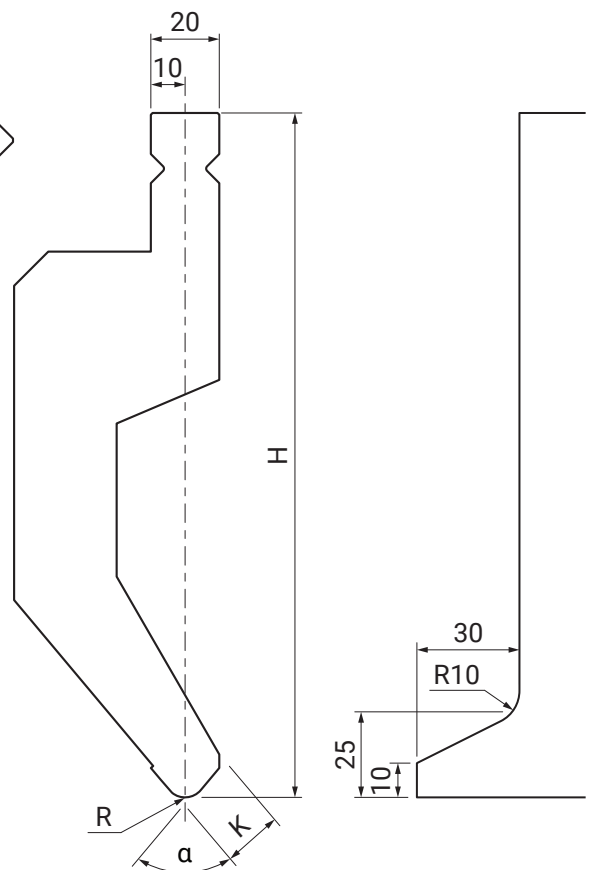
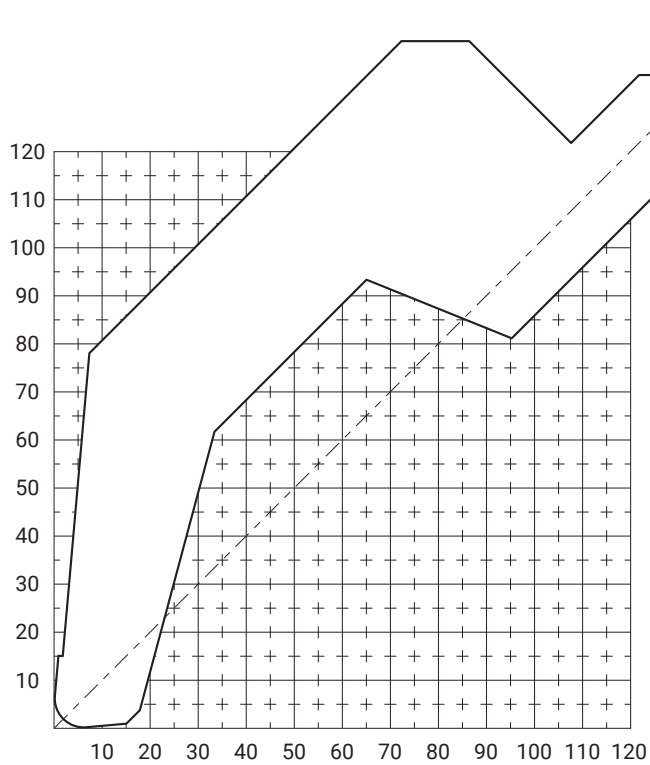

STANDARD 1V DIE 86° 90°

Material: **SCM440** Hardness: **HRC47 ± 3**

Standard length : 500mm · 300mm · 200mm

Sectioning TR : 550 mm

Type	V	α	R	W1	W2	H	A	Max	Product No.	Shape
	(mm)	Angle	(mm)	(mm)	(mm)	(mm)	(mm)	(ton/m)		
STANDARD 1V DIE	6	86	1.0	30	14	75	4	100	COD-021-075	i
						120			COD-021-120	
	16					75			COD-010-075	
						120			COD-010-120	
	10				20	75	5		COD-022-075	
						120	4		COD-022-120	
	12				-	75	7		COD-011-075	
						120			COD-011-120	
	16	-	75	5	COD-012-075					
			120		COD-012-120					
	20	2.0	75	5	COD-023-075					
			120		COD-023-120					
	6	90	1.0	30	14	75	4	100	COD-041-075	i
						120			COD-041-120	
	16					75			COD-042-075	
						120			COD-042-120	
	10				20	75	5		COD-043-075	
						120	4		COD-043-120	
	12				-	75	7		COD-044-075	
						120			COD-044-120	
	16	-	75	5	COD-045-075					
			120		COD-045-120					
	20	2.0	75	5	COD-046-075					
			120		COD-046-120					

■ i

■ ii

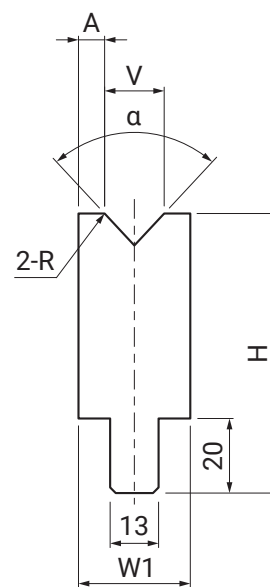
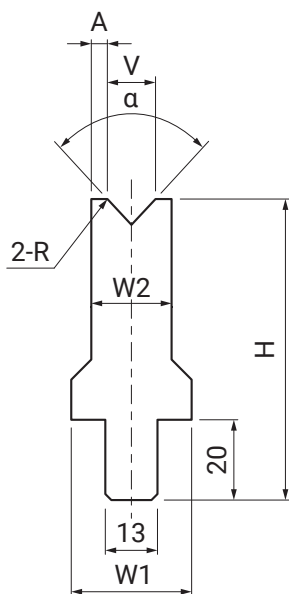

ACUTE ANGLE DIE 30°

Material: **SCM440** Hardness: **HRC47 ± 3**

Standard length : 500mm · 300mm · 200mm

Sectioning TR : 550 mm

Type	V	α	R	W1	W2	H	A	Max	Product No.	Shape
	(mm)	Angle	(mm)	(mm)	(mm)	(mm)	(mm)	(ton/m)		
ACUTE ANGLE DIE	6	30	1.0	30	16	75	5	20	COD-061-075	i
						120			COD-061-120	
	8			30	20	75	6	30	COD-051-075	
						120			COD-051-120	
	10			30	24	75	7	35	COD-062-075	
						120			COD-062-120	
	12			30	28	75	8	35	COD-052-075	
						120			COD-052-120	
	16	1.5	30	75	7	35	COD-053-075			
				120			COD-053-120			
	20	2.0	35	75	7.5	35	COD-063-075			
				120			COD-063-120			
	24	2.5	40	75	8	35	COD-054-075			
				120			COD-054-120			

■ i

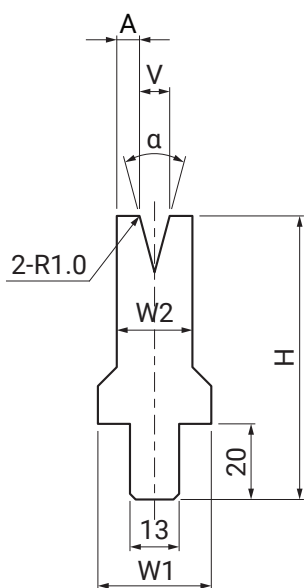

■ ii

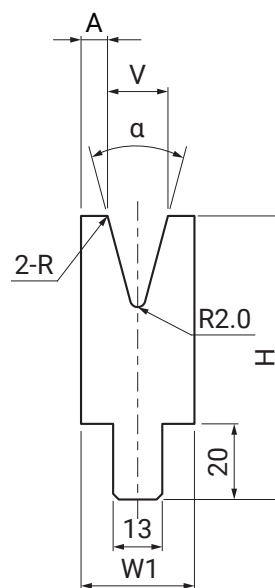

ACUTE ANGLE DIE 40°, HEMMING DIE

Material: **SCM440** Hardness: **HRC47 ± 3**

Standard length : 500mm · 300mm · 200mm

Sectioning TR : 550 mm

Type	V	α	R	W	H	A	Max	Product No.	Shape
	(mm)	Angle	(mm)	(mm)	(mm)	(mm)	(ton/m)		
ACUTE ANGLE DIE	30	40	3.0	50	120	10	70	COD-031-120	iii
	40		4.0	60	120			COD-032-120	iv

Type	V	R	H1	H2	W	Max	Product No.	Shape
	(mm)	(mm)	(mm)	(mm)	(mm)	(ton/m)		
HEMMING DIE	6	1.0	100	60	60	50	COD-082-100	v
			120				COD-082-120	
	10		100				COD-083-100	
			120				COD-083-120	

■ iii

■ iv

■ v

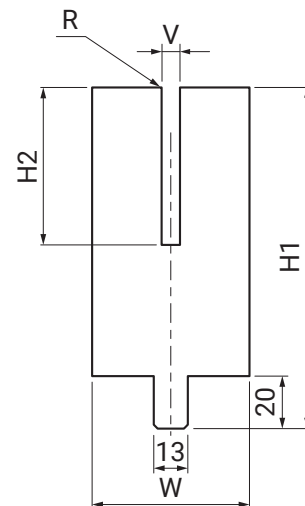
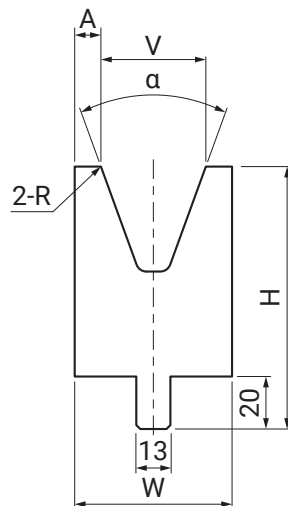
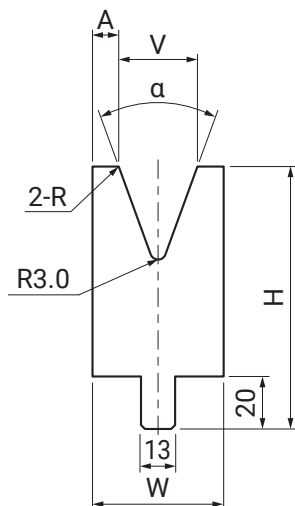

LARGE 1V DIE

Material: **SCM440** Hardness: **HRC47 ± 3**

Standard length : 500mm · 300mm · 200mm

Sectioning TR : 550 mm

Type	V	α	R	W	H	A	Max	Product No.	Shape
	(mm)	Angle	(mm)	(mm)	(mm)	(mm)	(ton/m)		
LARGE 1V DIE	24	80	2.5	40	75	8	90	COD-013-075	vi
					120			COD-013-120	
	30		75	10	COD-014-075				
			120		COD-014-120				
	40		75	7.5	COD-015-075				
			120		COD-015-120				
	50		75	10	COD-035-075				
			120		COD-035-120				
	80		120	COD-017-120	vii				
	100		12.5	COD-018-120					

Type	V	α	R	W	H	A	Max	Product No.	Shape
	(mm)	Angle	(mm)	(mm)	(mm)	(mm)	(ton/m)		
LARGE 1V DIE	60	60	6.0	80	120	10	100	COD-016-120	vii
	120	70	12.0	150	140	15	170	COD-070-140	

■ vi

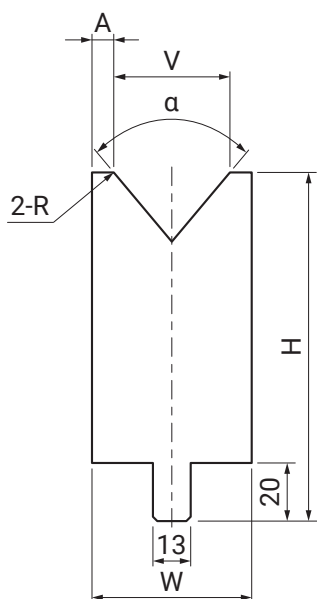

■ vii

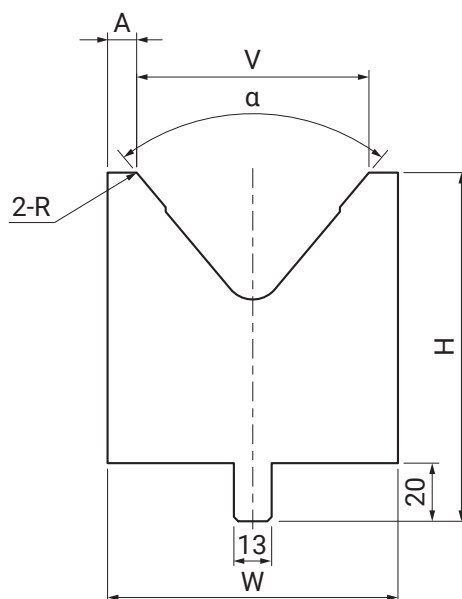

BEND CHART

t : Material thickness
(Tensile Strength 450~500N/mm²)

F : Pressure per 1m (kN/m)
ir : Radius of punch tip

b : Minimum length of flange
v : Width of die

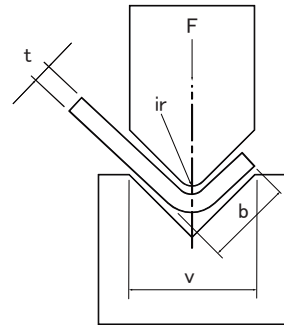

For mild steel

t	4	6	7	8	10	12	14	16	18	20	25	32	40	50	63	80	100	125	160	200	250	v
(mm)	2.8	4	5	5.5	7	8.5	10	11	13.5	14	17.5	22	28	35	45	55	71	89	113	140	175	b
0.5	40	30																				ir
0.6	60	40	40																			
0.8		70	70	50	40																	
1		110	100	80	70	60																
1.2			140	120	110	80	70	60														
1.4				150	130	110	100	90	80													
1.5				200	170	150	130	110	100	90												
1.6					170	150	130	110	100	90												
2						220	190	170	150	130	110											
2.3							250	230	190	170	150	120										
2.6								280	250	220	180	140										
3									340	300	240	190	150									
3.2										340	270	220	170	140								
3.5											330	260	200	160	130							
4											430	340	270	210	170							
4.5												440	340	270	210							
5												520	420	330	260	210						
6													600	480	380	300	240					
7														520	410	330	260					
9																670	540	430				
10																	850	670	530	420		
12																		960	780	600	550	
16																			1360	1070	860	
19																				1500	1250	1000
20																				1700	1350	1080
22																					1600	1300
25																					2100	1700
30																						2400

F (kN)

For stainless

t	4	6	7	8	10	12	14	16	18	20	25	32	40	50	63	80	100	125	160	200	250	v
(mm)	2.8	4	5	5.5	7	8.5	10	11	13.5	14	17.5	22	28	35	45	55	71	89	113	140	175	b
0.5	60	50																				ir
0.6	90	60	60	60																		
0.7	120	80	80	60	60																	
0.8		110	110	80	70																	
0.9		130	120	100	90	70																
1		170	150	120	110	90																
1.2			210	180	150	120	110	90														
1.5				290	230	200	170	150	130	120												
2						330	290	260	230	200	170											
2.5								390	350	300	250	190										
3									510	450	360	290	230									
4											650	510	410	320	260							
5												780	630	500	390	320						
6													900	720	570	450	360					
8															1020	810	650	510				
10																1290	1010	800	630			
12																	1440	1170	900	830		
15																		1800	1410	1140		
20																			2500	2080	1670	
25																				3150	2550	
30																						3600

F (kN)

Bending Tool Quote / Order Form

High Quality & Technology For **The Future**



CONIC CO., LTD.

Tool Sales Desk

Date/ (MM) (DD) (YYYY)

Page
/

URL www.conic.co.jp

EMAIL tools@conic.co.jp

CONIC's Person in charge: _____

1. Quote		2. Order	
Your company name	Country	TEL + (0)	Preferred delivery date
Person in charge		FAX + (0)	/ (MM) (DD)
Email			

Machine maker's name	Name of machine (for example: TRUBEND)	Machine spec
<input type="checkbox"/> TRUMPF <input type="checkbox"/> e.t.c ()		CAPACITY : kN(ton) TABLE LENGTH : L = mm OPEN HEIGHT : H = mm

Tool Material	Series	Clamp Type		
<input checked="" type="checkbox"/> JAPAN - TYPE	<input checked="" type="checkbox"/> TRUMPF TYPE	<input type="checkbox"/> STANDARD TYPE	<input type="checkbox"/> SAFETY-PIN TYPE	<input checked="" type="checkbox"/> SAFETY KEY TYPE

Product No. (for example: COP-016-157)	Quantity					Remarks
	500 mm	SECTIONING TR 550 mm	SECTIONING 300 mm	SECTIONING 200 mm	(Other)	

◆ Please draw special shapes here.

TRUMPF TYPE

CONIC HIGH PERFORMANCE TOOLING

- AMADA TYPE TOOLING
- TRUMPF TYPE TOOLING
- MURATA TYPE TOOLING
- KOMATSU TYPE TOOLING
- TOYOKOKI TYPE TOOLING
- NISSHINBO TYPE TOOLING

Download for your mobile



High Quality & Technology For  The Future
CONIC

CONIC CO., LTD

10-5 Taihei-dai, Shoo-cho, Katsuta-gun, Okayama 709-4321 Japan

Tel: (+81) 868 38 6154 | Fax: (+81) 868 38 6331

Email: tools@conic.co.jp | Website: www.conic.co.jp

CONIC PRECISION CO., LTD

55/22 moo 4. Buengkumphroy, Lumlukka, Phatumthani 12150 Thailand

Tel: (+66) 2 159 9870-1 | Fax: (+66) 2 159 9872

Email: conic_thai@conic.co.jp | Website: www.conic.co.jp/thai/

Dealer