

FEATHER HEMMING

Bolt Type / Rail Type

Sharp angle bending and hemming bending can be performed with a single die, ideal for reducing man-hours in the hemming process!

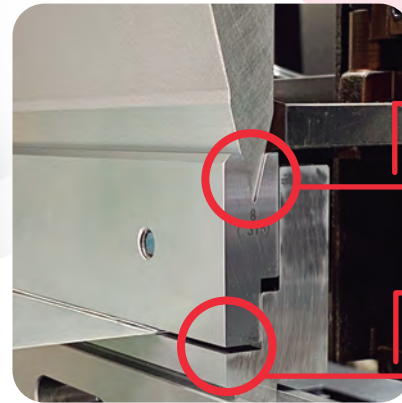

Process 1:
Sharp angle bending

Process 2:
Hemming bending

- High precision, high durability, and light weight
- Safety is emphasized, and the specifications are designed to be strong and resistant to breakage
- A wide variety of shapes are available to accommodate various die holders
- Widely applicable from corner hemming to split hemming
- It is designed to prevent slipping even when hemming bending of SUS

Supports complex hemming bending

Split-size feather hemming allows hemming of products with notches or side flanges. Expanded processing range with die holder attachment enables corner hemming with 90° bends.

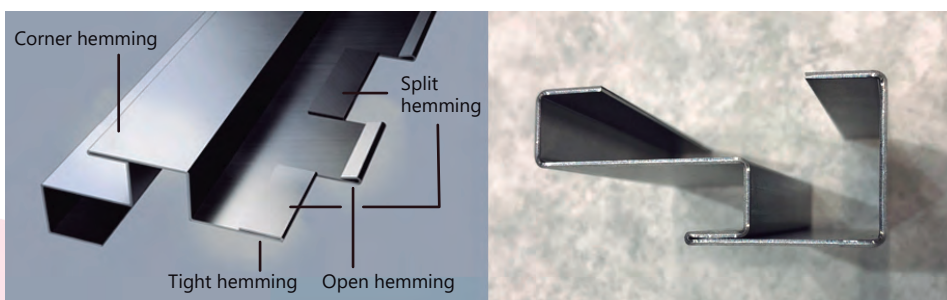

Reference Dimensions for Corner Hemming

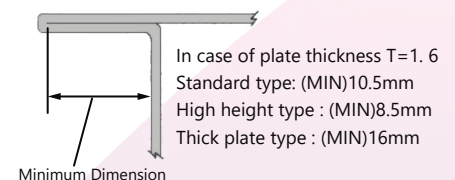

About Feather Hemming Adaptive Punch

Use a 30° punch with a tip of R0.7 or less.
 If the punch tip R becomes large due to wear or other reasons, the V-groove will bite into the punch, lifting the tool or die holder and causing it to fall off, which is very dangerous.
 Even when using a punch with a tip of R0.7 or less, fix the main unit firmly to the slide (table) for safety.

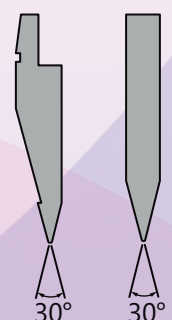



Bolt Type

2V die holder is available for use.

Standard bolt type	V-Width	6	8
	Maximum thickness	SPCC : 1.2mm SUS : 1.0mm	SPCC : 1.6mm SUS : 1.2mm
V Angle	30°		
Weight	L(835mm) 15kg S(415mm) 8kg		
Guaranteed withstand pressure	First step=50ton/m Second step=80ton/m		

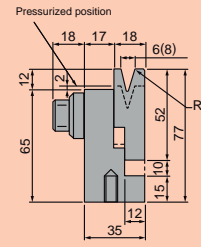

Mounting Example

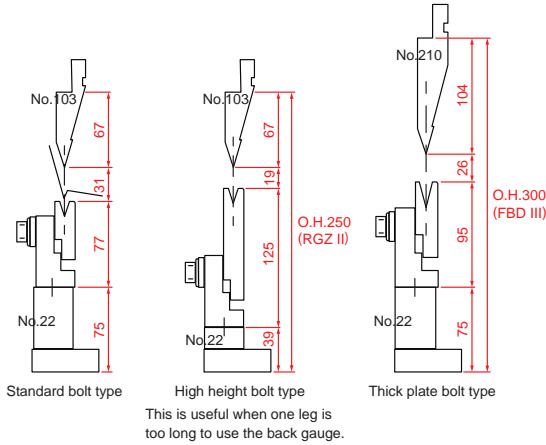

High height bolt type	V-Width	6	8
	Maximum thickness	SPCC : 1.2mm SUS : 1.0mm	SPCC : 1.6mm SUS : 1.2mm
V Angle	30°		
Weight	L(835mm) 21kg S(415mm) 11kg		
Guaranteed withstand pressure	First step=50ton/m Second step=80ton/m		

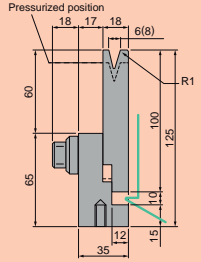

Thick plate bolt type	V-Width	10	12
	Maximum thickness	SPCC : 2.0mm SUS : 1.5mm	SPCC : 2.3mm SUS : 1.5mm
V Angle	30°		
Weight	L(835mm) 18kg S(415mm) 9kg		
Guaranteed withstand pressure	First step=55ton/m Second step=100ton/m		

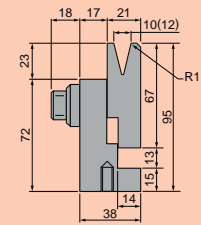

Rail Type

2V die rail is available for use.

Rail type	V-Width	6	8
	Maximum thickness	SPCC : 1.2mm SUS : 1.0mm	SPCC : 1.6mm SUS : 1.2mm
V Angle	30°		
Weight	L(835mm) 18kg, S(415mm) 9kg (Sectioning 8) 10kg, (Sectioning 11) 18kg		
Guaranteed withstand pressure	First step=50ton/m Second step=80ton/m		

Sectioning detail : (Sectioning 11) 50·55·60·65·70·75·80·85·90·95·100=825mm
(Sectioning 8) 45·50·55·60·65·70·75=470mm

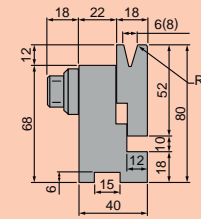

Mounting Example

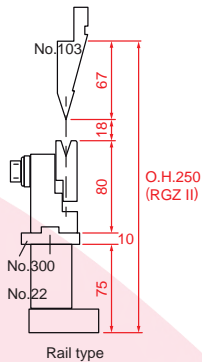

★For other specifications, please contact us.